

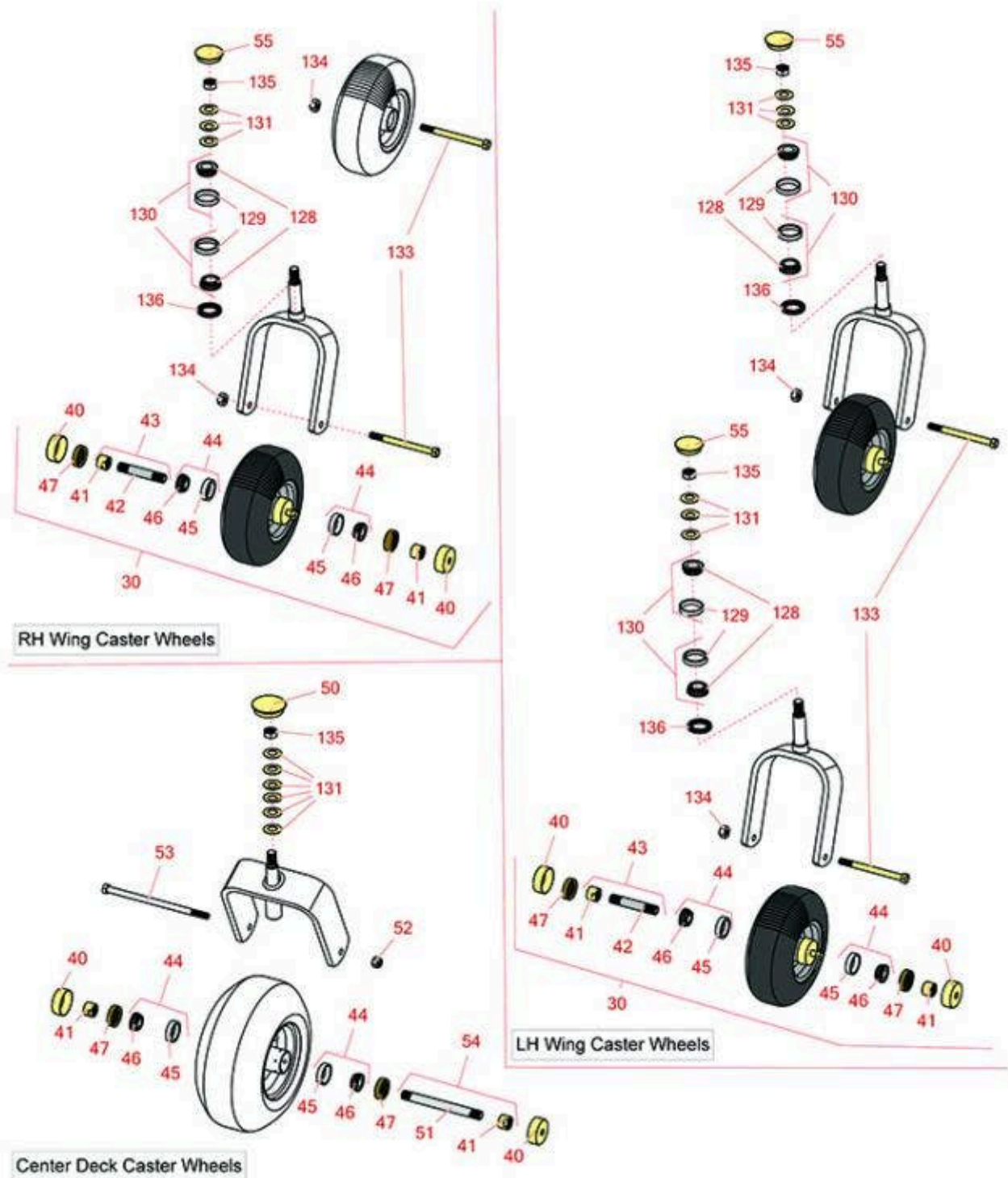

Replaces Toro Z Master Professional 7500-D Parts

Zero-Turn Mower with 96in Deck - Model 72096
Caster Wheel



All original equipment manufacturers names and part numbers are used for identification purposes only, and we are in no way implying that our products are original equipment parts. Prices subject to change without notice.



Replaces Toro Z Master Professional 7500-D Parts

Zero-Turn Mower with 96in Deck - Model 72096
Caster Wheel



Item No	R&R Part No.	OEM Part No.	Description	Qty Req	Order Quantity
---------	--------------	--------------	-------------	---------	----------------

Tires

30	R130-4558	112-3810, 112-8310, 130-4558	Wheel-Tire and Bearing Assy	3	
----	------------------	------------------------------------	-----------------------------	---	--

Other Parts Available

40	R103-2768	103-2768	Guard - Seal	10	
----	------------------	----------	--------------	----	--

41	R103-3051	103-3051	Spacer - Nut - Hardened	10	
----	------------------	----------	-------------------------	----	--

42	R103-3157	103-3157	Axle - Caster Wheel	3	
----	------------------	----------	---------------------	---	--

43	R126-5359	126-5359	Caster Axle Assy w/Bushing	3	
----	------------------	----------	----------------------------	---	--

44	R500534	1-633585	Bearing - with Cup	10	
----	----------------	----------	--------------------	----	--

45	R254-79	01-103-0060, 01-103-0130, 1-633584, 252-106, 254-79, 32-7800, 32-9590	Cup - Bearing	10	
----	----------------	---	---------------	----	--

Tech Note: Use R254-79M installation mandrel to properly install race.:

46	R254-78	01-102-0060, 01-102-0130, 1-633585, 254-78, 32-7790, 32-9580, 93-4813	Tapered Bearing Cone	10	
----	----------------	---	----------------------	----	--

47	R103-0063	103-0063	Seal - Grease	10	
----	------------------	----------	---------------	----	--

50	R126-9369	126-9369	Grease Cap - Castor	2	
----	------------------	----------	---------------------	---	--

51	R103-5156	103-5156	Axle- Caster	2	
----	------------------	----------	--------------	---	--

All original equipment manufacturers names and part numbers are used for identification purposes only, and we are in no way implying that our products are original equipment parts. Prices subject to change without notice.



Replaces Toro Z Master Professional 7500-D Parts

Zero-Turn Mower with 96in Deck - Model 72096
Caster Wheel



Item No	R&R Part No.	OEM Part No.	Description	Qty Req	Order Quantity
52	RF5003	32127-29, 32131-5, 32132-5, 3296-23	Locknut - ESNA 1/2-13	2	
53	R325-39	325-39	Bolt - Hx HD 1/2-13 x 9 1/2	2	
54	R126-5361	126-5361	Axle Assy - with Bushing - Caster	2	
55	R103-4882	103-4882	Grease Cap - Castor	3	
128	R254-94	1-543509, 254-94, 32-8090, 32-8240, 32-9640, 40440, 62-3330	Tapered Bearing Cone	6	
129	R254-72	01-103-0050, 01-103-0120, 01-103-0140, 1-543508, 254-71, 254-72, 40439, 62-3340, 99-4511	Cup - Bearing	6	
130	R500596		Tapered Bearing Set - Cup and Cone	6	
131	R1-633508	1-633508	Washer - Spring Disc	21	
133	R325-20	01-150-1250, 01-178-0848, 325-20	Bolt - Hx HD 1/2-13 x 6	4	
134	R3296-25	30-3380, 32127-21, 32127-31, 3290-160, 3290-33, 3296-13, 3296-25, 3296-45, 329645	Locknut - 1/2-13 Heavy ESNA	4	

All original equipment manufacturers names and part numbers are used for identification purposes only, and we are in no way implying that our products are original equipment parts. Prices subject to change without notice.



Replaces Toro Z Master Professional 7500-D Parts

*Zero-Turn Mower with 96in Deck - Model 72096
Caster Wheel*



Item No	R&R Part No.	OEM Part No.	Description	Qty Req	Order Quantity
135	R3296-51	3296-51, 3296-81	Nut - Nylon Lock 3/4-10 Gr 8	5	
136	R1-543511	1-543511	Seal- Grease	3	

All original equipment manufacturers names and part numbers are used for identification purposes only, and we are in no way implying that our products are original equipment parts. Prices subject to change without notice.