

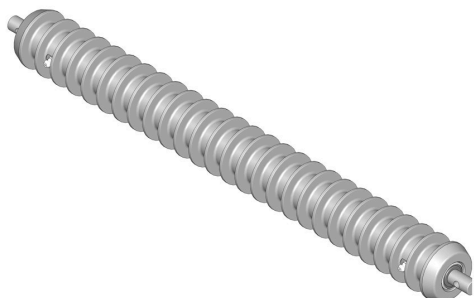

Roller - Grooved Machined Solid Steel

R75-1520



Details

Machined from solid steel this heavy weight roller uses greasable "water-pump" style bearings.

Replaces

Toro	75-1520
------	---------

Specifications

Manufacturer	R&R Products
Roller Body	2.5 in
Diameter	
Weight (lbs)	16 lb

Fits Models

Toro Reelmaster 223D
Toro Reelmaster 5100-D
Toro Reelmaster 5300-D
Toro Reelmaster 5400D

Replacement Parts

R75-1290	Bearing - Roller
R302-5	Fitting - Grease

Amacron Golf & Turf

19 Tate Drive Kerang, 3579

+61 2 8011 1001 Toll Free: 1300 AMACRON

<https://amacron.rrproducts.com/>