

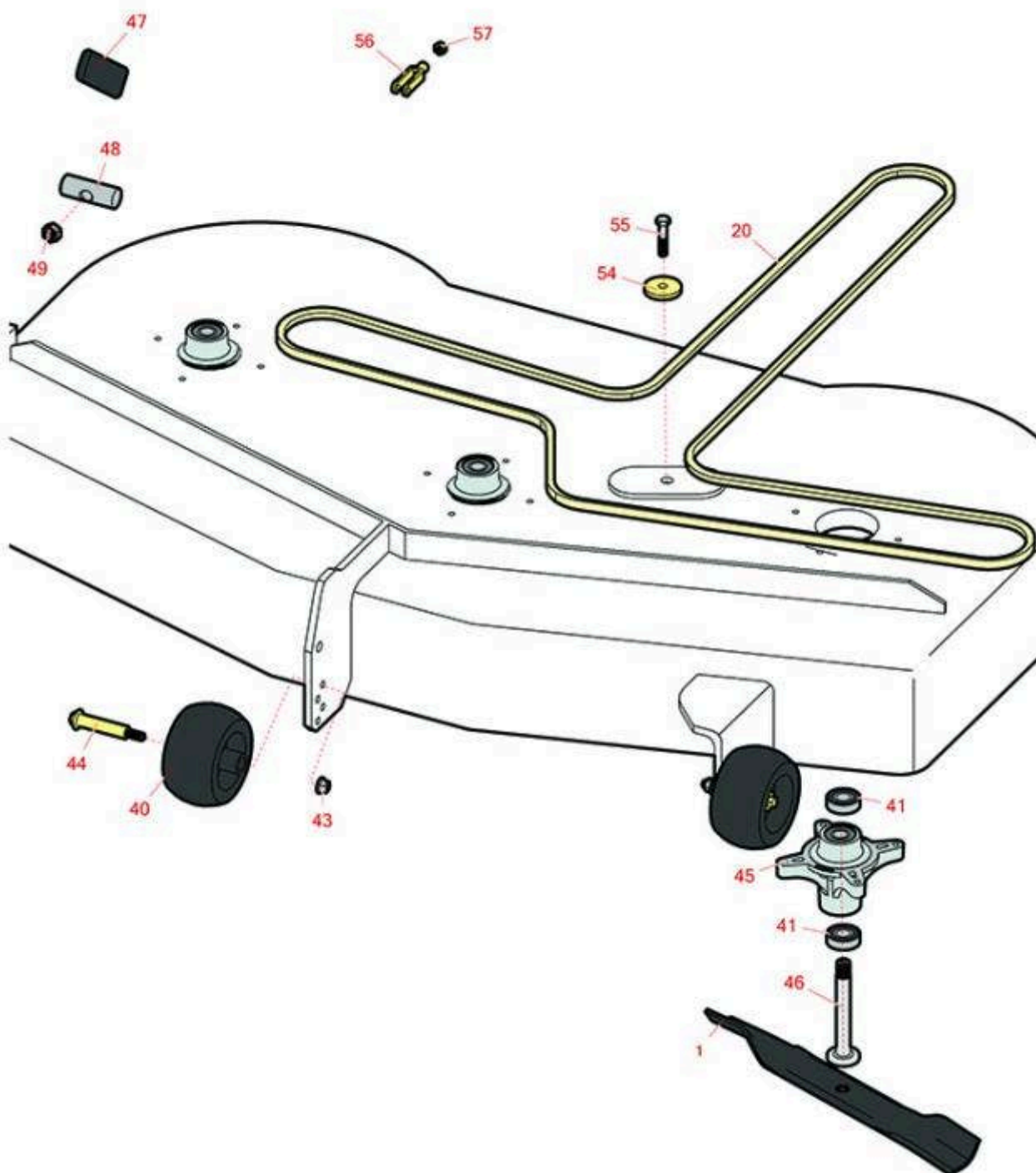

# Replaces Exmark Quest Front Steer Parts

Zero-Turn Mower with 50in Deck - Models  
QSS708GEM50200  
50in Deck Parts



All original equipment manufacturers names and part numbers are used for identification purposes only, and we are in no way implying that our products are original equipment parts. Prices subject to change without notice.



# Replaces Exmark Quest Front Steer Parts

Zero-Turn Mower with 50in Deck - Models  
QSS708GEM50200  
50in Deck Parts



Item No	R&R Part No.	OEM Part No.	Description	Qty Req	Order Quantity
<b>Blades</b>					
1	<b>R115-5059-03</b>	115-5059-03	Mower Blade - High Lift 17.5 in	3	
<b>Belts</b>					
20	<b>R119-8820</b>	119-8820	Belt	1	
<b>Other Parts Available</b>					
40	<b>R68-2730</b>	1-603299	Wheel - Anti Scalp	3	
41	<b>R343667</b>	38-7820	Bearing - Ball	2	
41	<b>R38-7820</b>	100-1048, 38-7820	Bearing - Ball	2	
43	<b>R104-8301</b>	104-8301, 109-6658	Locknut - 3/8-16 Nylon Flanged	9	
44	<b>R112-3977</b>	112-3977	Bolt- Shoulder	3	
45	<b>R139-3214</b>	121-0751, 121-9107	Spindle Assy	3	
46	<b>R117-7268</b>	117-7268	Shaft- Spindle	3	
47	<b>R1-633268</b>	1-633268	Grip - Lever - Foam	1	
48	<b>R119-8810</b>	119-8810	Pivot Pin	1	
49	<b>R3296-19</b>	3296-19	Locknut - 1/2-20	1	
54	<b>R110-9981</b>	110-9981	Washer-Plain	1	
55	<b>R323-9</b>	323-9	Bolt - Hex HD 3/8-16 x 1-3/4	4	
56	<b>R282-2</b>	1-303105	Yoke	2	
57	<b>R3220-2</b>	3220-2	Nut - Jam - 5/16-24	2	

All original equipment manufacturers names and part numbers are used for identification purposes only, and we are in no way implying that our products are original equipment parts. Prices subject to change without notice.