

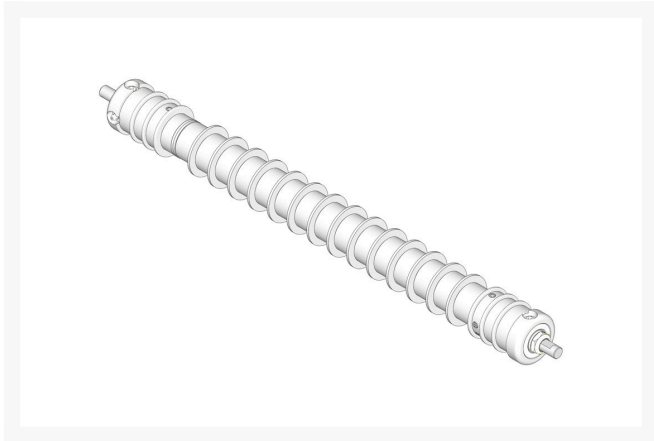

# Roller - Grooved Repairable Steel

RLMAA356RG



## Details

Constructed with a through shaft and greasable tapered bearings for extended life, this roller can be repaired by unscrewing the ends and replacing the series of washers and spacers. Body Length: 27-1/2" & Shaft Length: 31-3/4"

## Replaces

R&R Products RLMAA356G

## Specifications

|                      |              |
|----------------------|--------------|
| Manufacturer         | R&R Products |
| Overhaul Kit No.     | R100135      |
| Roller Body Diameter | 2.75 in      |
| Weight (lbs)         | 20 lb        |

## Fits Models

Ransomes 213, 350 & 5/7 Fairway

## Replacement Parts

|          |                              |
|----------|------------------------------|
| R100135  | Overhaul Kit - Roller        |
| R500534  | Bearing - with Cup           |
| R150670  | Roller End - 2-3/4 Threaded  |
| R328059  | Shaft - Grooved Roller       |
| R150672  | Washer - 2-3/4 Roller        |
| R150676  | Spacer - 2-3/4 Dia x 1-1/4 L |
| R150678  | Spacer - Grooved Roller 3/4  |
| R150676A | Spacer - 1/8                 |
| R150691  | Screw - Set Nyloc            |

## Amacron Golf & Turf

19 Tate Drive Kerang, 3579

+61 2 8011 1001 Toll Free: 1300 AMACRON

<https://amacron.rrproducts.com/>



# Roller - Grooved Repairable Steel

RLMAA356RG



|          |                           |
|----------|---------------------------|
| R170714  | 3/8-16 x 3/8              |
| R302-5   | Fitting - Pressure Relief |
| R253-122 | Fitting - Grease          |
| R254-79  | Seal                      |
| R254-78  | Cup - Bearing             |
| R150674  | Tapered Bearing Cone      |
|          | Sleeve - Wear 3/4         |
|          | Plated                    |
| R253-117 | Seal - Outer Triple Lip   |
| R3296-15 | Locknut - 3/4-16 Nylon    |
|          | Jam                       |

## Amacron Golf & Turf

19 Tate Drive Kerang, 3579

+61 2 8011 1001 Toll Free: 1300 AMACRON

<https://amacron.rrproducts.com/>