

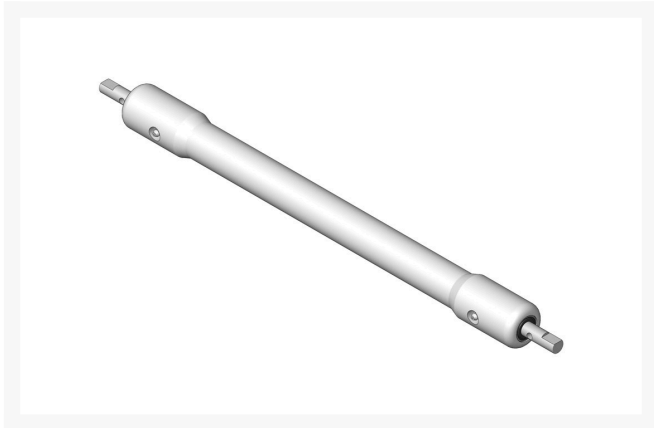

# Roller - Swaged Machined Aluminum

R101122



## Details

Constructed with "water-pump" style bearings, this steel tubular roller contacts the ground only on the outer 2-7/8" of the roller.

## Specifications

Manufacturer	R&R Products
Roller Body	2 in
Diameter	
Weight (lbs)	4 lb

## Fits Models

- Jacobsen Eclipse 122F
- Jacobsen E-Plex
- Jacobsen E-Plex II
- Jacobsen Greens King II
- Jacobsen Greens King IV
- Jacobsen Greens King V & VI
- Jacobsen G-Plex III
- Jacobsen PGM 19
- Jacobsen PGM 22

## Replacement Parts

R21-8430	Bearing - Roller
R302-5	Fitting - Grease

## Amacron Golf & Turf

19 Tate Drive Kerang, 3579

+61 2 8011 1001 Toll Free: 1300 AMACRON

<https://amacron.rrproducts.com/>