

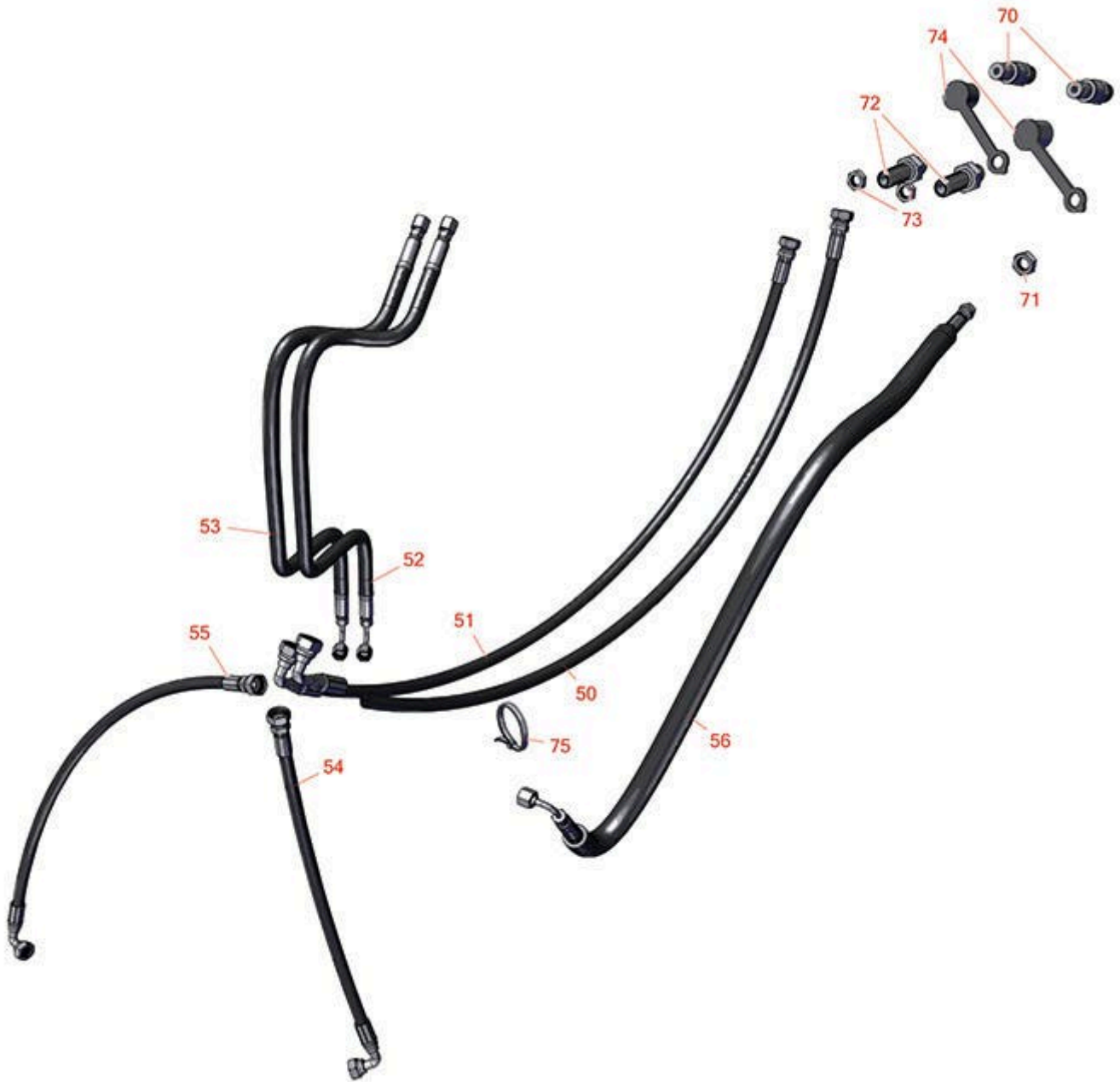

Replaces Toro Groundsmaster 4000-D Parts

*Rotary Mower - Model 30609
Lift, Steer and Fan Hydraulic Assembly*



All original equipment manufacturers names and part numbers are used for identification purposes only, and we are in no way implying that our products are original equipment parts. Prices subject to change without notice.



Replaces Toro Groundsmaster 4000-D Parts

Rotary Mower - Model 30609
Lift, Steer and Fan Hydraulic Assembly



| Item No | R&R Part No. | OEM Part No. | Description | Qty Req | Order Quantity |
|------------------------------|------------------|--|---------------------|---------|----------------|
| Hoses | | | | | |
| 50 | R127-3737 | 127-3737 | Hydraulic Hose Assy | 1 | |
| 51 | R127-3738 | 127-3738 | Hydraulic Hose Assy | 1 | |
| 52 | R127-3736 | 127-3736 | Hydraulic Hose Assy | 1 | |
| 53 | R100-3833 | 100-3833 | Hydraulic Hose Assy | 1 | |
| 54 | R121-1567 | 121-1567 | Hydraulic Hose Assy | 1 | |
| 55 | R121-1566 | 121-1566 | Hydraulic Hose Assy | 1 | |
| 56 | R106-3692 | 106-3692 | Hydraulic Hose Assy | 1 | |
| Other Parts Available | | | | | |
| 70 | R59-7410 | 59-7410 | Tip-Nipple | 2 | |
| 71 | R340-127 | 340-127 | Nut - Bulkhead | 2 | |
| 72 | R340-71 | 340-71 | Fitting - Straight | 2 | |
| 73 | R340-70 | 340-70 | Nut - Lock | 2 | |
| 74 | R354-79 | 354-79 | Cap-Dust | 2 | |
| 75 | R3290-378 | 30-1740, 3290-378, 52-6570, 60-4340 | Cable Tie | 7 | |

All original equipment manufacturers names and part numbers are used for identification purposes only, and we are in no way implying that our products are original equipment parts. Prices subject to change without notice.