

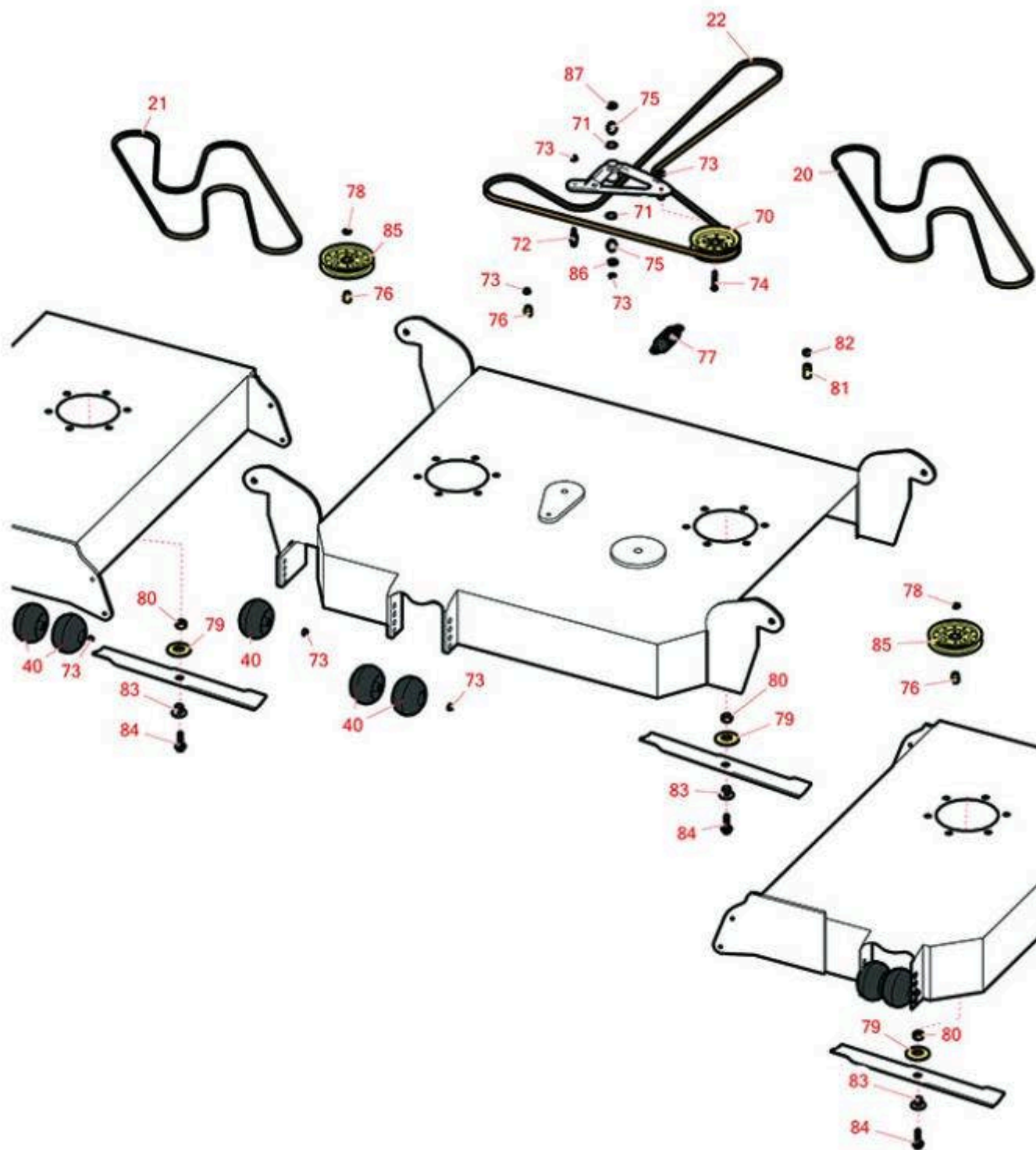

## Replaces Exmark Lazer Z X-Series Parts

Zero Turn Mower with 96in Deck - Models LZX980EKC96RW0  
96in Deck



All original equipment manufacturers names and part numbers are used for identification purposes only, and we are in no way implying that our products are original equipment parts. Prices subject to change without notice.



## Replaces Exmark Lazer Z X-Series Parts

Zero Turn Mower with 96in Deck - Models LZX980EKC96RW0  
96in Deck



Item No	R&R Part No.	OEM Part No.	Description	Qty Req	Order Quantity
<b>Belts</b>					
20	<b>R126-6442</b>	126-6442	Belt-V	1	
21	<b>R126-6447</b>	126-6447	V-Belt	1	
22	<b>R126-6440</b>	126-6440	V-Belt	1	
<b>Rollers</b>					
40	<b>R103-8415</b>	103-8415	Roller - Anti Scalp	13	
<b>Other Parts Available</b>					
70	<b>R126-9196</b>	126-9196	Idler Pulley - Flat	1	
71	<b>R106-7159</b>	106-7159	O-Ring	2	
72	<b>R126-0423</b>	126-0423	Pin - Spring - Anchor	1	
73	<b>R104-8301</b>	104-8301, 109-6658	Locknut - 3/8-16 Nylon Flanged	90	
74	<b>R104-3396</b>	104-3396	Bolt - Hex HD 3/8-16 x 2-1/4	1	
75	<b>R103-3504</b>	103-3504	Bearing - Spherical	2	
76	<b>R1-633456</b>	1-633456	Bushing - Idler	6	
77	<b>R116-6317</b>	116-0133, 116-6317	Spring - Extension	3	
78	<b>R98-5975</b>	98-5975	Washer - Belleville	16	
79	<b>R103-1330</b>	103-1330	Guard - Bearing - Top	3	
80	<b>R116-7306</b>	116-7306	Hex Nut - 3/4-16 with Nyloc	6	
81	<b>R109-7840</b>	109-7840	Adjuster - Lift - Deck	4	
82	<b>R443818</b>	3218-5	Nut - 1/2-13 Hex Jam Zinc	4	

All original equipment manufacturers names and part numbers are used for identification purposes only, and we are in no way implying that our products are original equipment parts. Prices subject to change without notice.



## Replaces Exmark Lazer Z X-Series Parts

Zero Turn Mower with 96in Deck - Models LZX980EKC96RW0  
96in Deck



Item No	R&R Part No.	OEM Part No.	Description	Qty Req	Order Quantity
83	<b>R103-3037</b>	103-3037	Splined Bushing	4	
84	<b>R109-9220</b>	109-9220	Bolt - Sems 1/2-20	4	
85	<b>R116-4667</b>	116-4667, 126-7685	Idler -Pulley - Flat	2	
86	<b>R103-3505</b>	103-3505	Seal - Double Lip	2	
87	<b>R103-3506</b>	103-3506	Seal - Single Lip	2	

All original equipment manufacturers names and part numbers are used for identification purposes only, and we are in no way implying that our products are original equipment parts. Prices subject to change without notice.